

AECOM Delivering a Better World



As the world's trusted infrastructure consulting firm, AECOM is committed to constantly striving for better – whether by reducing emissions, creating social value, or enlivening the cities and places we work to transform. We understand both the urgency of the challenges our society faces and our responsibility to respond in an impactful and enduring way. Therefore, we are instigating change toward a more sustainable and equitable future, partnering with those who want to make a positive difference.

Since AECOM's founding, the firm's size, revenue, geographic footprint, portfolio of capabilities, and market dynamics have evolved. However, what has not changed is the core of who we are: a global team of the best minds collaborating to help deliver a better world.

Thinking without limits is what keeps us at the vanguard. Ideas have no borders, and this ethos is embedded in our culture.

Looking ahead, we're further emphasizing the transformational impact our people make each day. We're also differentiating our brand by championing our expanded definition of infrastructure that includes all the systems, structures, and environments that make our communities work.

AECOM Urbanism + Planning

As a part of Urbanism + Planning (U+P), the practice of design is a focus of the Hong Kong Landscape Studio. U+P brings landscape architecture, urban design, planning, sustainable development, and economics together to enrich communities and cities. We execute innovative projects with imaginative, performance-based, data-driven design solutions. We strive to inspire and be inspired. Designing meaningful places, revealing inherent value, and enlivening places, communities, and cities are fundamental to who we are.

The Studio and the Role of Landscape Architecture in Place Making and Sustainable Environments

The AECOM Hong Kong Landscape Studio strives for excellence and sees opportunities to explore new ways of practice through inclusive collaboration. Our multi-disciplinary approach looks holistically at the bigger picture: how social, cultural, economic, and natural forces transform the way people experience and engage their environment. We nurture and create positive change at the intersection of these forces.

The drive to do good, be curious, and integrate diverse thinking sustains our work. Ideas are our currency giving us agency to develop innovative sustainable solutions. Yet, as a practitioner, creativity and imagination are not enough. The drive to the practice of landscape architecture requires tenacity and a belief in what is possible. And that the role of design and designers is paramount to understanding, revealing, and creating unique, vibrant places, environments, and cities.

So why these projects? These projects show diverse scale, and how important the bigger picture is in redefining the public realm, sustainability, and the social and cultural dynamic of Hong Kong to our process and studio. This mindset and these priorities are part of AECOM. Our studio prioritizes place-making and the public realm to cultivate a sustainable future; from green infrastructure to bespoke smart office environments, we see no boundaries within the landscape but an interconnected, evolving, and ever-changing environment.

Rethinking Hong Kong's Public Realm

Hong Kong is a dynamic city. Its beauty can be found in its contrasts and its diversity. The creation of the cityscape has primarily been an infrastructure-led story of expedience. Development has shaped the city's cultural character in a hyper-urbanized way, often at the expense of a quality open space. For Hongkongers, the goal of creating a more liveable urban public realm has been elusive. However, there has been a realization that Hong Kong needs to integrate a greener urban dynamic in significant infrastructure projects and smaller, more lifestyle-focused commercial urban projects. This trend has opened new ways of thinking about city-making, integrating sustainable systems into infrastructural ones, and investing in creating new urban opportunities to redefine infrastructure and green open space, promoting a more environmental, social, and economic sustainable agenda. As the city carries on through the Covid-19 pandemic, we believe a greener, more sustainable, and resilient Hong Kong will emerge.

West Kowloon Terminus

RE-IMAGINING GREEN INFRASTRUCTURE AND THE CONNECTED LANDSCAPE

SCALES OF PLANNING STRATEGY

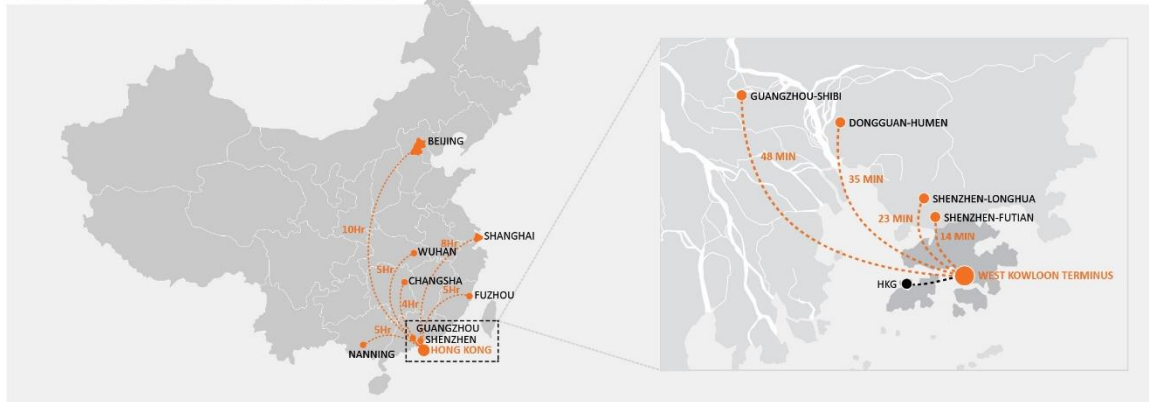

West Kowloon Terminus (WKT) is the underground high-speed rail terminus of the Hong Kong Section of the Guangzhou-Shenzhen-Hong Kong Express Rail Link (XRL), occupying a prominent 6-hectare site; the station is a significant new gateway to the city. The landscape design for WKT creates a contemporary "architectural" companion that embraces and expands on the theme of the station architecture. The confluence of movement within and out of the WKT site is the driver of landscape forms, with circulation and movement at its forefront. The designed green landscape spaces act as a connective fabric allowing continuity of movement and integration into the urban fabric, promoting porosity between the spaces and elements of the WKT and its urban surroundings. This connectivity results in a more robust relationship with the city, the West Kowloon Cultural District, and the harbor front. Sustainable design was also a priority. We designed green parkscapes and gardens throughout the station structure and onto the roof trusses, ribbons of skylights for natural lighting into the station and concourse area. Recycled materials and native planting were maximized to reduce the heat island effect. These also encouraged visitors to explore the station's landscapes from the promontory of the structure to the ground level at the Civic Plaza, creating an accessible pedestrian circulation system for West Kowloon. In addition, the landscape accommodates various public events while providing a comfortable, leisurely green environment.

The West Kowloon Terminus represents a new typology of green infrastructure where a sustainable landscape and connected public realm is paramount to creating a more livable, green Hong Kong. The West Kowloon Terminus is a 2019 IFLA Award winner.

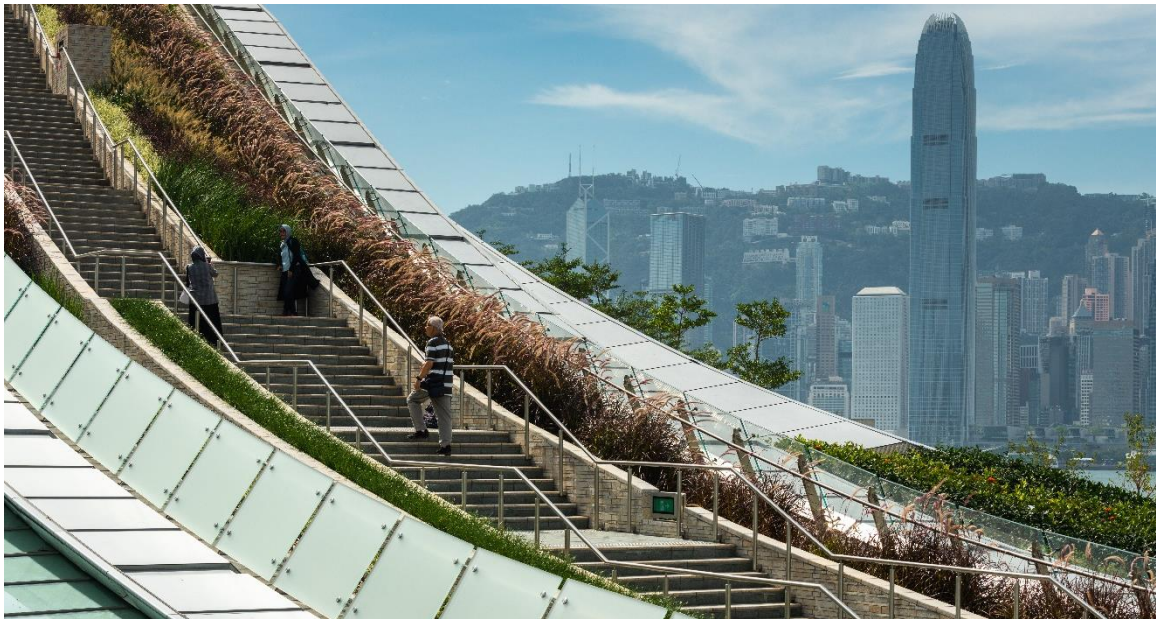

Kai Tak Cruise Terminal

CREATING A HYBRID GREEN PUBLIC REALM AT THE KAI TAK CRUISE TERMINAL

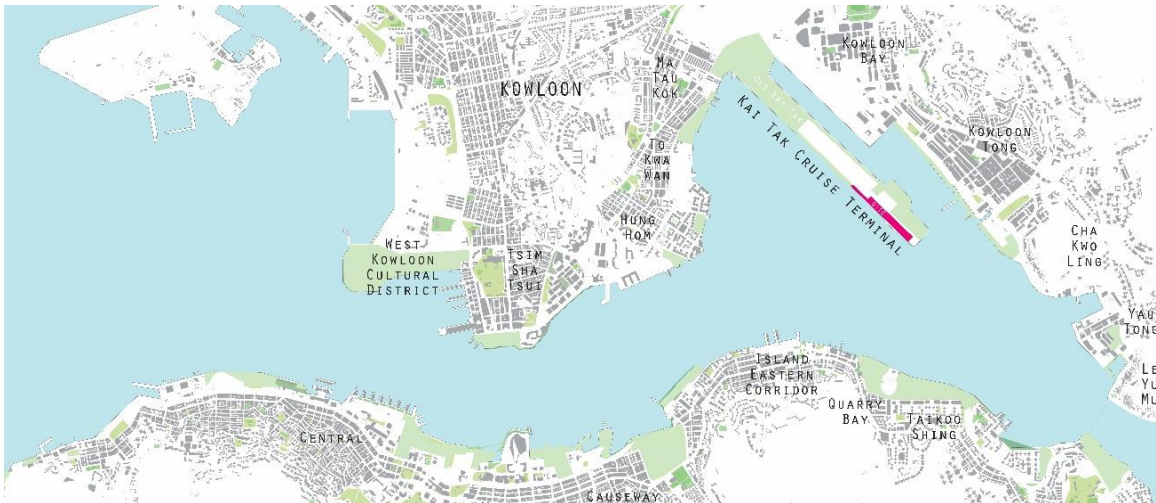

This project transforms the urban landscape of Hong Kong by revitalizing the old Kai Tak Airport site and the Kowloon Waterfront. The Kai Tak Cruise Terminal introduced a significant new urban hub to the city. Its dynamic architecture, integrated landscapes, and green roof park redefine the public realm at the heart of one of the world's most densely urban environments. It also re-establishes this iconic site as a new tourism gateway and a green urban destination for those who live and visit Hong Kong.



The Cruise Terminal and its landscape design comprise a series of interconnected architectural decks with a large open rooftop park. This becomes one of the Terminal's key features. As one of the largest elevated parks in Asia, measuring 800 meters long and 80 meters wide, the park resonates with a sense of place by knitting together three distinct Hong Kong landscapes, the verdant surrounding hills, the energy of the city, and the waterscape of Victoria Harbour. Designed to accommodate a wide range of activities, the park's design maximizes access to 360-degree views of the harbor and the city. The park seamlessly integrates the iconic architecture with the landscape. The undulating roof forms are reflected in the landscape as a series of planted architectural landforms or "green waves," creating a hybrid landscape of contemporary forms integrated with sustainable systems. The design weaves these designed forms and systems into diverse program zones of leisure activities, urban recreation, and educational spaces. These zones create a spatial narrative that defines and composes the programs and landscape spaces into botanical gardens, water gardens, open lawns, and performance spaces, creating playful and memorable moments and experiences. As a result, the Terminal and its landscape have become more than just a place for tourism but an urban venue for arts, civic, recreation, and cultural events.

Kai Tak Cruise Terminal is a bridge to the city's memory and a new landmark creating a greener future for Hong Kong. This project is a testament to how Hong Kong continues to redefine itself and its priorities to better service a sustainable, livable urban environment.



BESPOKE SMART OFFICE ENVIRONMENTS

People-centric is how we describe our approach to bespoke smart office environments. Our mindful processes harmonize an active urban lifestyle, work/life balance, convenience, and information technologies to create flexible, productive, efficient work environments.

Placemaking drives the seamless design thinking between the site, landscape, architecture, and interiors. Both vertical and horizontal connectivity is vital to linking landscape, people, and urban office environment and lifestyle activities.

Lee Garden 3, Causeway Bay

SUSTAINABILITY AND BIODIVERSITY INSPIRE LIVING ENVIRONMENTS IN THE CITY

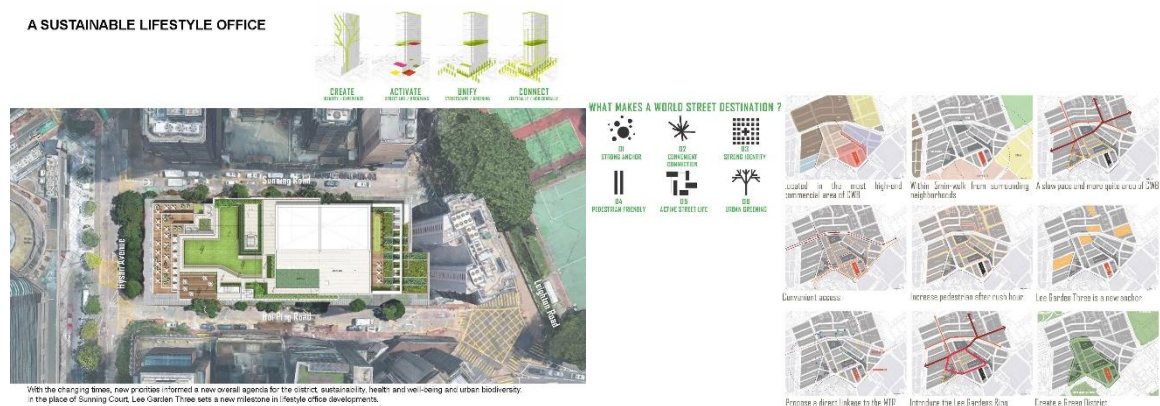

The Lee Garden 3 is an exciting project in two ways: first, our scope looked at a holistic study of the urban dynamic of Causeway Bay to revitalize this iconic shopping district and, second, the demolition and redevelopment and forward-thinking design of an existing office tower to create a new urban retail office destination, the Lee Garden Three lifestyle office tower.

Both expressed the desire of our client to create a vibrant retail district that better addresses walkability, sustainability, and biodiversity. With this mandate, we worked to re-energize the street culture by better delineating the district's shopping streets through the lens of ecology, wellness, and lifestyle. In addition, our strategies better unified the district by utilizing materiality, accessibility, and connectivity to create a recognizable aesthetic while allowing for adaptation, artful expression, and greening. These strategies were then incorporated into the landscape design of the office tower. Our landscape concept, "Greening from the Street to the Sky," expresses the urban lifestyle and ecologies of today's Hong Kong, where the need to create a more balanced and flexible office experience is part of its culture. Therefore, it was essential to utilize landscape on each floor from the street to the roof to cultivate the idea of a vertically connected green design. One unique design aspect was using the refuge floor to create a recreational and exercise lounge space to promote relaxation and well-being. It has become one of the most used and beloved spaces devoted to the new lifestyle trends where work-life balance and an engaged, productive urban workforce find a place to lounge, hold events, do yoga, and exercise.



Lee Garden 3 represents our approach to defining and developing bespoke projects. By looking at the character and sustainability of the entire district, we could better identify specific project objectives and how they best serve the overall purposes of the client, city, and the people who live and work in Hong Kong. As a result, the project strived to create a sustainable benchmark and was awarded BEAM Plus Platinum and received LEED Gold accreditation.



The Quayside, Kwun Tong

WELLNESS AND MINDFULNESS ARE SMART AND SUSTAINABLE

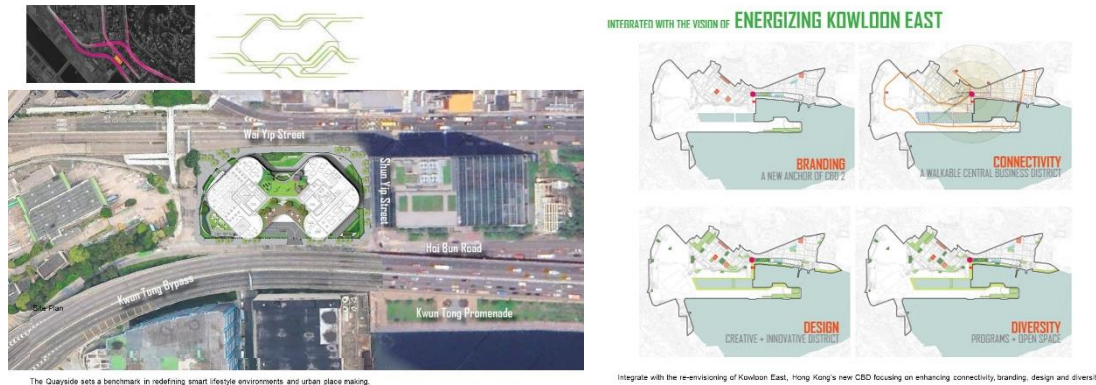

The Quayside sets a benchmark in redefining smart lifestyle environments and urban place-making.

Integrate with the re-envisioning of Kowloon East, Hong Kong's new CBD focusing on enhancing connectivity, branding, design and diversity.

The Quayside sets a benchmark in redefining smart lifestyle environments and urban place-making. This holistic approach engages a new series of essential sustainable priorities and cultivates social interaction to create a new typology for urban development focused on flexibility, health, and wellness. Vibrancy is paramount in this ethos and is expressed in the design of the public and commercial realm, its spatial architecture, and the vertically integrated creative systems that form the framework for designing its commercial, retail, and people spaces. In addition, it re-establishes fundamental attitudes about the importance of a more integrated nature and embraces a greener environmental mindfulness. These concepts were essential in the goals of its designers and developers to establish a new paradigm.



THE QUAYSIDE
RE-ENERGIZE / RECHARGE / REPRODUCE

The Quayside is a 24-story mixed-use office development designed to integrate smart, sustainable, and green systems that allow for a people-centric, fun environment. The overall design connects with the framework of Kowloon East and its green urban infrastructure, embracing the overall district, site, and public spaces of Quayside. The project is located on a 2.2-hectare gateway site at a nexus of expressway and road

systems. The project's urban dynamics and landscape embrace the building and site, creating its unique green identity and spatial quality. This attitude and its focus on green, balanced environments are expressed through its adherence to sustainable principles, energy efficiency, and human productivity. These aspects are integrated into every part of the design, from water management to energy harvesting and urban farming. We also wanted the concept of wellness to encapsulate a more robust response to work-life balance, livability, and connectivity. Our process in designing Quayside was to truly consider how flexibility and resilience can create new bespoke outcomes.

The architecture and landscape design create a vertically integrated series of lifestyle commercial, retail, and green spaces leading through the building up to the open green roofscape. These spaces provide opportunities for respite, relaxation, exercise, and exchange. One essential space is the public living lounge on the 5th floor with views of the new Kai Tak Development area and the Cruise Terminal. The other is the green roofscape designed for celebration and events, as well as designating a garden area for urban farming.

As Hong Kong transforms, new developments must engage how people participate in their work environments. We believe Quayside serves as a guide to creating a holistic vision where smart technologies, sustainable systems, and collective experience best achieve a new blueprint for mindful performance-based workplaces. As a result, the project was awarded the BEAM Plus Platinum.

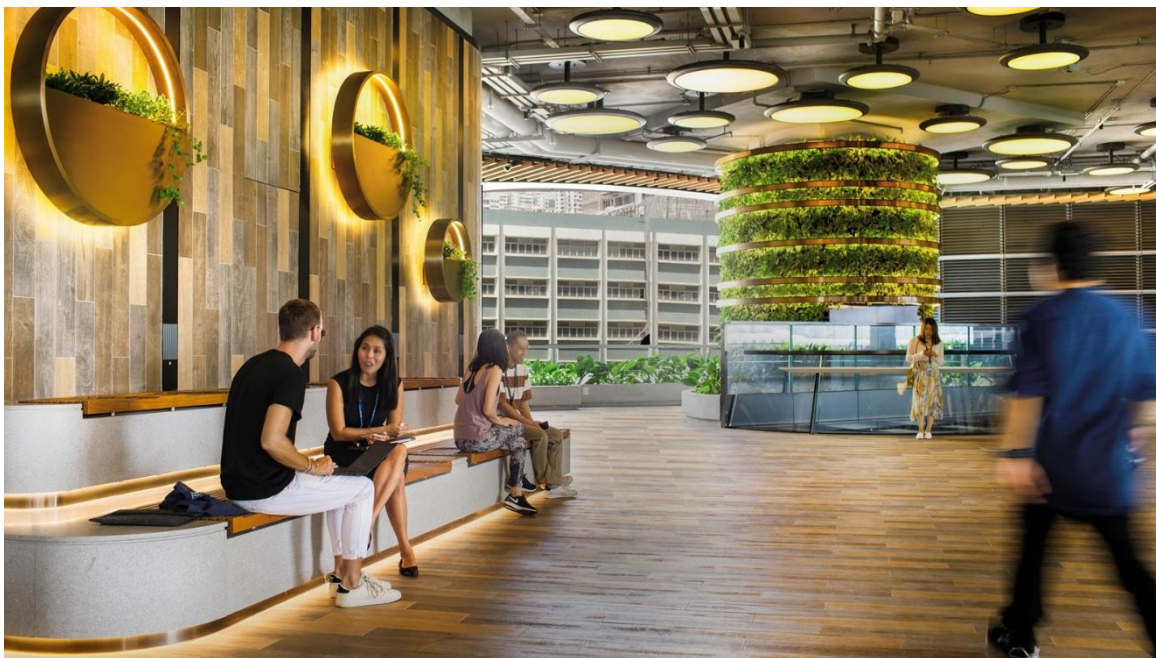

Connecting our practice to sustainability and the public realm

The selected projects showcased AECOM's broader platform, where collaboration and multi-business line practices can create new methods of design. We envision places with more comprehensive view of our environment and the cities we live in. Grounded in place-making to create memorable and innovative environments and communities, the important role of landscape architecture conveys the urgent need to rethink how our work considers, implements, and prioritizes fundamental local and global goals. Redefining the role of place-making, environmental and social sustainability, resilience, and resonance drives how we see and understand our world. We know the promise of a more holistic approach and the opportunities it affords us to deliver a better future.

