

OASIS TERRACES

Oasis Terraces is a new generation neighbourhood centre that comprises communal facilities, shopping, amenities and a government polyclinic. The uniqueness of this project is how it is able to bring the experience of the outdoors and nature so extensively and seamlessly into the interior spaces of the development for both the Neighbourhood Centre and the Polyclinic. Hanging Gardens around the entire external façade and Garden terraces extending right into the depth of the development.

The closeness of nature and landscape enhances the experience of building users and occupants. The uniqueness of the building is also highly visual and recognizable and is becoming a landmark feature for the residents in Punggol.

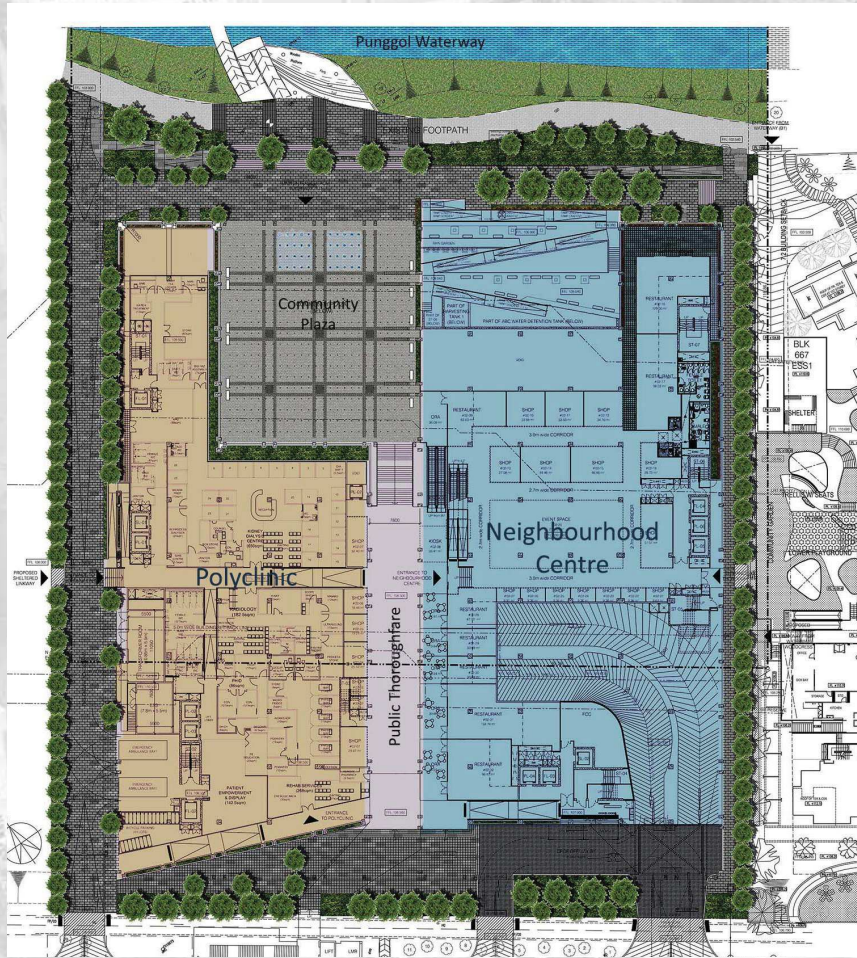

Oasis Terraces is designed with a continuous main-thoroughfare which connects the main road along Punggol Drive directly to the Punggol Waterway. The main -thoroughfare, the main -spine between the Neighbourhood Centre and the Polyclinic, is accessible to public for 24/7.



Oasis Terraces is designed with a sheltered-linkway which is directly connected to the Oasis LRT Station. This provides convenient access for the residents to the healthcare facilities in Punggol Polyclinic as well as various neighbourhood amenities like F&B and supermarket.



The Community Plaza in Oasis Terraces is an open sheltered space with generous 20 m high ceiling designed for multi-functional communal activities. The seamless connection to the water-front sets the Punggol Waterway as an idyllic backdrop during these activities.